

Slotted Hex Nut

Thread Type: Metric - Fine

Thread Direction: Right Hand

Material: Carbon Steel

Class Grade: Low Tensile Class 5

Finish: Zinc Plated

Corrosion Protection Level: Moderate

Standard: DIN 935

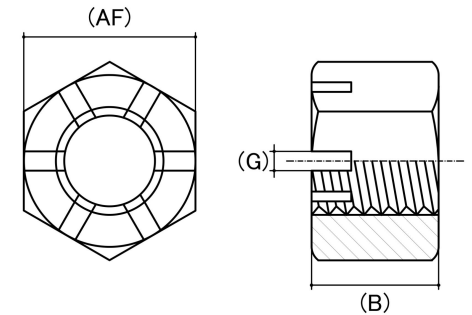

CAD drawings shown for graphic representation only.*

Size	Thread Pitch (mm)	Thread Type	Overall Nut Height (B) (mm)		Groove Width (W) (mm)	Groove Height (H) (mm)	Across Flats (AF) (mm)		Spanner Size (AF) (mm)	sku (qfind)
			Min	Max	Nom	Nom	Min	Max		
M8	1.00	Fine	9.14	9.50	2.80	2.50	12.73	13.00	13	41SLMF8100
M10	1.25	Fine	11.57	12.00	2.90	4.05	15.73	16.00	16	41SLMF10125
M12	1.50	Fine	14.57	15.00	3.70	4.30	17.73	18.00	18	41SLMF12150
M16	1.50	Fine	18.48	19.00	4.50	6.00	23.67	24.00	24	41SLMF16150
M20	1.50	Fine	21.16	22.00	4.60	6.00	29.16	30.00	30	41SLMF20150
M24	2.00	Fine	26.16	27.00	5.65	8.40	35.16	36.00	36	41SLMF24200

Disclaimer:

Dimensional data and technical information was obtained from publically available sources and not acquired through standard agencies. It has been completed and compiled for reference purposes only; where discrepancies are found they are subject to change without notice. Bolt & Nut Australia makes no warranties or representations regarding the accuracy and validity of the compiled information and data.

Contact the relevant standard authorities for accurate and detailed information.

* CAD drawings may not reflect diameter, thread length or overall length.

© Bolt & Nut Australia Pty Ltd. All rights reserved.

Version: 18 Mar 2024